

Leicester
City Council

HEARING UNDER THE LICENSING ACT 2003

DATE: WEDNESDAY, 19 MARCH 2014

TIME: 9:30 am

**PLACE: THE COUNCIL CHAMBER - FIRST FLOOR, TOWN HALL,
TOWN HALL SQUARE, LEICESTER**

Members of the Hearing Panel

Councillors Naylor, Riyait and Thomas

Members of the Hearing Panel are summoned to attend the above meeting to consider the items of business listed overleaf.

for Monitoring Officer

Officer contact: Angie Smith
Democratic Support,
Leicester City Council
Town Hall, Town Hall Square, Leicester LE1 9BG
Tel: 0116 454 6354
email: angie.smith@leicester.gov.uk

INFORMATION FOR MEMBERS OF THE PUBLIC

ACCESS TO INFORMATION AND MEETINGS

You have the right to attend Cabinet to hear decisions being made. You can also attend Committees, as well as meetings of the full Council. Tweeting in formal Council meetings is fine as long as it does not disrupt the meeting. There are procedures for you to ask questions and make representations to Scrutiny Committees, Community Meetings and Council. Please contact Democratic Support, as detailed below for further guidance on this.

You also have the right to see copies of agendas and minutes. Agendas and minutes are available on the Council's website at www.cabinet.leicester.gov.uk or by contacting us as detailed below.

Dates of meetings are available at the Customer Service Centre, 91 Granby Street, Town Hall Reception and on the Website.

There are certain occasions when the Council's meetings may need to discuss issues in private session. The reasons for dealing with matters in private session are set down in law.

WHEELCHAIR ACCESS

Meetings are held at the Town Hall. The Meeting rooms are all accessible to wheelchair users. Wheelchair access to the Town Hall is from Horsefair Street (Take the lift to the ground floor and go straight ahead to main reception).

BRAILLE/AUDIO TAPE/TRANSLATION

If there are any particular reports that you would like translating or providing on audio tape, the Democratic Services Officer can organise this for you (production times will depend upon equipment/facility availability).

INDUCTION LOOPS

There are induction loop facilities in meeting rooms. Please speak to the Democratic Services Officer at the meeting if you wish to use this facility or contact them as detailed below.

General Enquiries - if you have any queries about any of the above or the business to be discussed, please contact Angie Smith, Democratic Support on 0116 454 6354 or email Angie.Smith@leicester.gov.uk or call in at the Town Hall.

Press Enquiries - please phone the Communications Unit on 0116 454 4150

PUBLIC SESSION

AGENDA

- 1. APPOINTMENT OF CHAIR**
- 2. APOLOGIES FOR ABSENCE**
- 3. DECLARATIONS OF INTEREST**

Members are asked to declare any interests they may have in the business to be discussed.

- 4. ANY OTHER URGENT BUSINESS**

The Chair has agreed to take an item of urgent business to allow the application to be considered within the statutory time period for Temporary Event Notices.

OBJECTION NOTICE GIVEN FOR A TEMPORARY EVENT NOTICE: THE SPORTSMAN, PARK RISE, WESTERN PARK, LEICESTER, LE3 6SG.

- 5. OBJECTION NOTICE GIVEN FOR A TEMPORARY EVENT NOTICE: THE SPORTSMAN, PARK RISE, WESTERN PARK, LEICESTER, LE3 6SG** **Appendix AOUB1**

Report attached. A copy of the associated documentation is attached for Members only. Further copies are available on the Council's website at www.cabinet.leicester.gov.uk or by phoning Democratic Support on 454 6354.

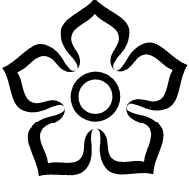

Leicester
City Council

WARDS AFFECTED
New Parks

FORWARD TIMETABLE OF CONSULTATION AND MEETINGS:
Hearing under the Licensing Act 2003

19th March 2014

Objection notice given for a Temporary Event Notice
The Sportsman, 43 Park Rise, Western Park, Leicester LE3 6SG

Report of the Director of Environmental Services

1. Purpose of Report

- 1.1. This report provides information for Members about an objection notice received in relation to a temporary event notice (TEN) given under the Licensing Act 2003, to assist them in determining the outcome.

2. Determination to be made

- 2.1. Having considered the temporary event notice and the objection notice, Members must consider whether to
- Give the premises user a counter notice under Section 105 (2) of the Licensing Act 2003 if it is considered appropriate for the promotion of a licensing objective to do so; or
 - Impose one or more conditions on the temporary event notice if:
 - it is appropriate for the promotion of the licensing objectives to do so, and
 - the condition(s) are also imposed on a premises licence or club premises certificate that has effect in relation to all or part of the same premises as the temporary, and
 - the condition(s) would not be inconsistent with the carrying out of the licensable activities under the temporary event notice; or
 - Disregard the objection notice

3. Summary

- 3.1 This report outlines an objection notice given by the Noise Team in response to a temporary event notice given by Mr Richard Gillespie for The Sportsman, 43 Park Rise, Western Park, Leicester, LE3 6SG. It also highlights the licensing objectives, the relevant parts of the guidance and regulations, and the pertinent sections of the Licensing Authority's Licensing Policy.

4. Location Plan

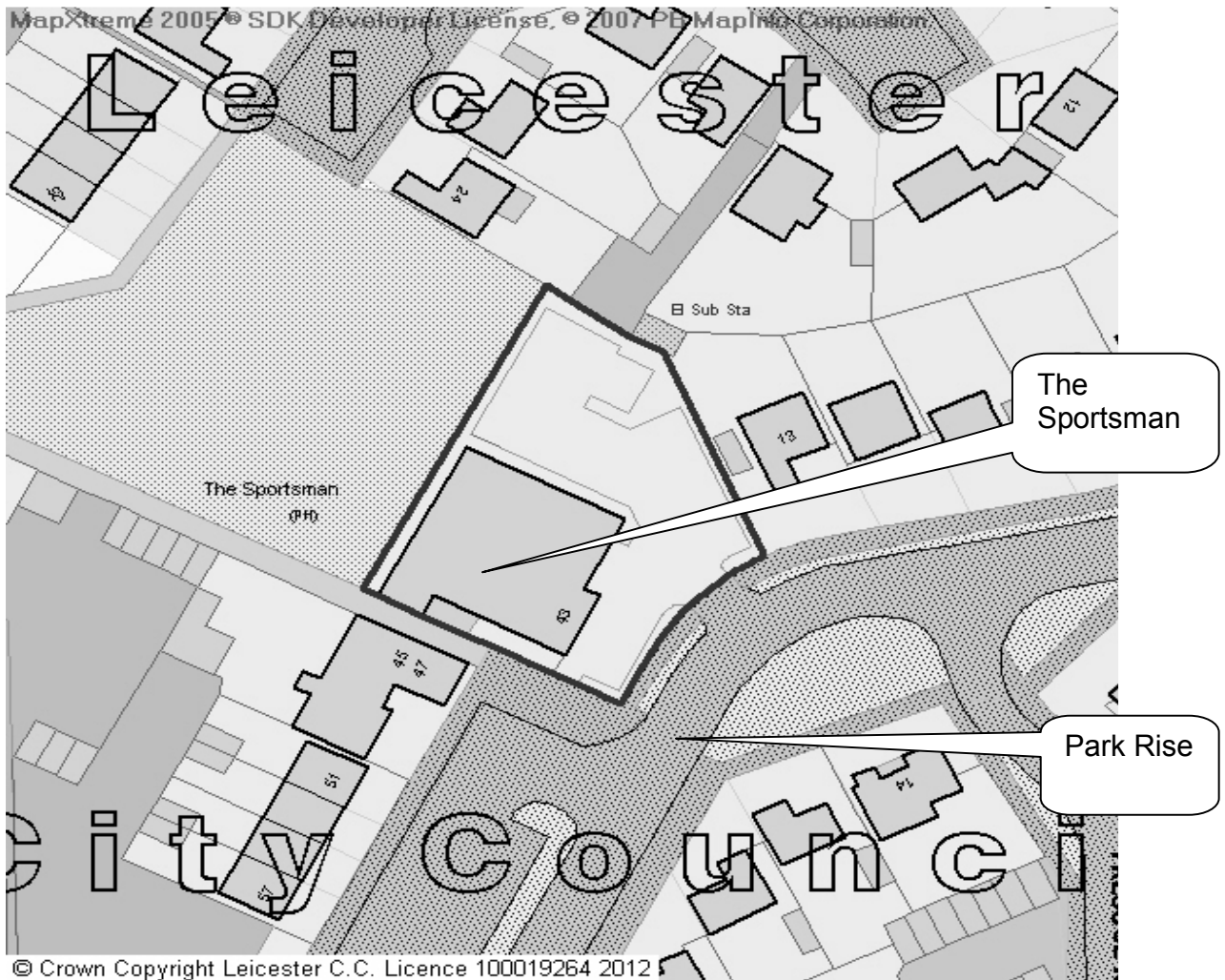

5. Temporary event notice

- 5.1. A temporary event notice was given on 11th March 2014 by Mr Richard Gillespie for an event at The Sportsman, 43 Park Rise, Western Park, Leicester, LE3 6SG. The temporary event notice is for an event on 28th, 29th and the 30th March 2014 and is attached at Appendix A.
- 5.2. The temporary event notice is for the following licensable activities:

Licensable activities	Proposed hours
The sale by retail of alcohol (for consumption on and off the premises) Provision of regulated entertainment Provision of late night refreshment	Friday to Saturday 1200 until 0600 Sunday 1200 until 2300

6. Objection notice

- 6.1 An objection notice was received on 12th March 2014 from the Noise Team on the grounds of the prevention of public nuisance. A copy of the objection notice is attached at Appendix B.

7. Existing premises licence

- 7.1 The premises identified in the temporary event notice is fully covered by an existing premises licence. One or more of the conditions on this premises licence may be applied to the temporary event notice if Members consider it appropriate for the promotion of the licensing objectives, and insofar as the conditions are not inconsistent with the carrying on of licensable activities under the notice. A copy of the existing premises licence, including the conditions are attached at Appendix C.

8. Statutory Guidance

- 8.1 Any decision made by the Licensing Authority must be in accordance with the licensing objectives. In addition, the government has issued guidance under section 182 of the Licensing Act 2003. The relevant parts of the guidance in this case are as follows:

Section	Heading
7.2 – 7.6	TEN – General
7.24 – 7.30	Role of the Licensing Authority
7.31 – 7.35	Police and Environmental Health intervention
7.37 – 7.38	Applying conditions to a TEN

9. Statement of Licensing Policy

- 9.1 The relevant parts of the Licensing Authority's Statement of Licensing Policy are as follows:

Section	Heading
2	Fundamental Principles
15	Temporary Event Notices

10. Other Implications

OTHER IMPLICATIONS	YES/ NO	Paragraph/References Within Supporting information
Equal Opportunities	No	
Policy	No	
Sustainable and Environmental	No	
Crime and Disorder	No	
Human Rights Act	No	
Elderly/People on Low Income	No	

Corporate Parenting	No	
Health Inequalities Impact	No	

11. Background Papers – Local Government Act 1972

- a. None

12. Consultations

- a. The Licensing Authority is not obliged to consult any parties with regard to temporary event notices. The applicant is required to serve a copy of their temporary event notice on the Police and the Noise Team.

13. Report Author

Chris Spencer
Licensing Officer
01164543051
Chris.spencer@leicester.gov.uk

APPENDIX	CONTENT
A	Temporary event notice
B	Objection notice
C	Existing premises licence

Appendix A

TEN
059727

Application ref: leicester-92263

Licence:

Applicant name:

Applicant email:

Submitted on:

Total fee:

Payment status:

Capita ref:

Amount paid: £21.00

Fee outstanding: £0.00

Application

Nicholas Richard Gillespie application form

Supporting documents (0)

Authority Reference

Reference:

Tacit consent applies

Process by: 24/03/2014

Status: Not collected

Recent History

Notification to
licensing@leicester.gov.uk:
Sent on 10/03/2014 19:06

Notification to
sportsman.leicester@phoenixpub.co.uk:
Sent on 10/03/2014 19:05

Payment Successful :
at 10/03/2014 19:05

If you're encountering a problem and require assistance, please contact us at licensing-authorities@digital.cabinet-office.gov.uk

[GOV.UK Licensing Terms and Conditions](#)

© GDS 2012



Leicester
Application for a Temporary Event Notice
Licensing Act 2003

For help contact
licensing@leicester.gov.uk
Telephone: +44 116 454 3040

* required information

Section 1 of 8

You can save the form at any time and resume it later. You do not need to be logged in when you resume.

System reference

Not Currently In Use

This is the unique reference for this application generated by the system.

Your reference

05032014

You can put what you want here to help you track applications if you make lots of them. It is passed to the authority.

Are you an agent acting on behalf of the applicant?

Yes

No

Put "no" if you are applying on your own behalf or on behalf of a business you own or work for.

Applicant Details

* First name

Nicholas Richard

* Family name

Gillespie

* E-mail

Main telephone number

Other telephone number

include country code.

Indicate here if you would prefer not to be contacted by telephone

Are you:

Applying as a business or organisation, including as a sole trader

Applying as an individual

A sole trader is a business owned by one person without any special legal structure. Applying as an individual means you are applying so you can be employed, or for some other personal reason, such as following a hobby.

Continued from previous page...

Your Address

Address official correspondence should be sent to.

* Building number or name	The Sportsman
* Street	43 Park Rise
District	Western Park
* City or town	Leicester
County or administrative area	Leicestershire
* Postcode	LE3 6SG
* Country	United Kingdom

Section 2 of 8

APPLICATION DETAILS (See also guidance on completing the form, general notes and note 1)

Have you had any previous or maiden names?

Yes

No

Applicant must be 18 years of age or older

* Your date of birth

<input type="text"/>	/	<input type="text"/>	/	<input type="text"/>
dd		mm		yyyy

National Insurance number

This box need not be completed if you are an individual not liable to pay UK national insurance.

Place of birth

Correspondence Address

Is the address the same as (or similar to) the address given in section one?

Yes

No

If "Yes" is selected you can re-use the details from section one, or amend them as required. Select "No" to enter a completely new set of details.

Building number or name	The Sportsman
Street	43 Park Rise
District	Western Park
City or town	Leicester
County or administrative area	Leicestershire
Postcode	LE3 6SG
Country	United Kingdom

Continued from previous page...

Additional Contact Details

Are the contact details the same as (or similar to) those given in section one?

If "Yes" is selected you can re-use the details from section one, or amend them as required. Select "No" to enter a completely new set of details.

Yes

No

E-mail

Telephone number

Other telephone number

Section 3 of 8

THE PREMISES

I, the proposed user, hereby give notice under section 100 of the Licensing Act 2003 of my proposal to carry out a temporary activity at the premises described below.

Give the address of the premises where you intend to carry on the licensable activities or if it has no address give a detailed description (including the Ordnance Survey references). [\(See also guidance on completing the form, note 2\)](#)

* Does the premises have an address?

Yes

No

Address

Is the address the same as (or similar to) the address given in section one?

If "Yes" is selected you can re-use the details from section one, or amend them as required. Select "No" to enter a completely new set of details.

Yes

No

* Building number or name

The Sportsman

* Street

43 Park Rise

District

Western Park

* City or town

Leicester

County or administrative area

Leicestershire

* Postcode

LE3 6SG

* Country

United Kingdom

* Does a premises licence or club premises certificate have effect in relation to the premises (or any part of the premises)?

Neither

Premises licence

Club premises certificate

* Premises licence number

LEIPRM0841

Location Details

* Provide further details about the location of the event

Public house with two bars and a garden

Continued from previous page...

If you intend to use only part of the premises at this address or intend to restrict the area to which this notice applies, give a description and details below [\(see also guidance on completing the form, note 3\)](#)

Describe the nature of the premises below [\(see also guidance on completing the form, note 4\)](#)

Describe the nature of the event below [\(see also guidance on completing the form, note 5\)](#)

Disco and karaoke with sale of alcohol to celebrate 1st year of trading with present landlord and landlady

Section 4 of 8

LICENSABLE ACTIVITIES

State the licensable activities that you intend to carry on at the premises [\(see also guidance on completing the form, note 6\)](#):

- The sale by retail of alcohol
- The supply of alcohol by or on behalf of a club to, or to the order of, a member of the club
- The provision of regulated entertainment
- The provision of late night refreshment
- The giving of a late temporary event notice

Late notices can be given no later than 5 working days but no earlier than 9 working days before the event.

[\(See also guidance on completing the form, note 7\).](#)

Event Dates

There must be a period of at least 10 working days between the date you submit this form and the date of the earliest event when you will be using these premises for licensable activities.

State the dates on which you intend to use these premises for licensable activities

[\(see also guidance on completing the form, note 8\)](#)

Event start date / /
 dd mm yyyy

The maximum period for using premises for licensable activities under the authority of a temporary event notice is 168 hours or seven days.

Event end date / /
 dd mm yyyy

Continued from previous page...

State the times during the event period that you propose to carry on licensable activities (give times in 24 hour clock)

12 til 06 12 til 06 12 til 11

(see also guidance on completing the form, note 9)

State the maximum number of people at any one time that you intend to allow to be present at the premises during the times when you intend to carry on licensable activities, including any staff, organisers or performers

200

Note that the maximum number of people cannot exceed 499.

(see also guidance on completing the form, note 10)

If the licensable activities will include the supply of alcohol, state whether the supplies will be for consumption on or off the premises, or both (see also guidance on completing the form, note 11):

- On the premises only
 Off the premises only
 Both

Section 5 of 8

PERSONAL LICENCE HOLDERS (See also guidance on completing the form, note 12)

Do you currently hold a valid personal licence? Yes No

Provide the details of your personal licence below.

Issuing licensing authority Newcastle-under-Lyme Borough Council

Licence number 009535

Date of issue 03 / 08 / 2005
dd mm yyyy

Date of expiry 02 / 08 / 2015
dd mm yyyy

Any further relevant details

Section 6 of 8

PREVIOUS TEMPORARY EVENT NOTICES (See also guidance on completing the form, note 13)

Continued from previous page...

Have you previously given a temporary event notice in respect of any premises for events falling in the same calendar year as the event for which you are now giving this temporary event notice?

Yes

No

Have you already given a temporary event notice for the same premises in which the event period:

a) Ends 24 hours or less before; or

Yes

No

b) Begins 24 hours or less after the event period proposed in this notice?

Section 7 of 8

ASSOCIATES AND BUSINESS COLLEAGUES [\(See also guidance on completing the form, note 14\)](#)

Has any associate of yours given a temporary event notice for an event in the same calendar year as the event for which you are now giving a temporary event notice?

Yes

No

Has any associate of yours already given a temporary event notice for the same premises in which the event period:

a) Ends 24 hours or less before; or

Yes

No

b) Begins 24 hours or less after the event period proposed in this notice?

Has any person with whom you are in business carrying on licensable activities given a temporary event notice for an event in the same calendar year as the event for which you are now giving a temporary event notice?

Yes

No

Continued from previous page...

Has any person with whom you are in business carrying on licensable activities already given a temporary event notice for the same premises in which the event period:

Yes

No

- a) Ends 24 hours or less before; or
- b) Begins 24 hours or less after the event period proposed in this notice?

Section 8 of 8

CONDITION

It is a condition of this temporary event notice that where the relevant licensable activities described in Section 4 above include the supply of alcohol that all such supplies are made by or under the authority of the premises user. [\(See also guidance on completing the form, note 16\)](#)

PAYMENT DETAILS

This fee must be paid to the authority. If you complete the application online, you must pay it by debit or credit card. This formality requires a fixed fee of £21

ATTACHMENTS

AUTHORITY POSTAL ADDRESS

Address

Building number or name	<input type="text"/>
Street	<input type="text"/>
District	<input type="text"/>
City or town	<input type="text"/>
County or administrative area	<input type="text"/>
Postcode	<input type="text"/>
Country	<input type="text" value="United Kingdom"/>

DECLARATION

This section should be completed by the applicant, unless you answered "Yes" to the question "Are you an agent acting on behalf of the applicant?"

* Full name	<input type="text"/>
* Capacity	<input type="text"/>
Date (dd/mm/yyyy)	<input type="text"/>

Continued from previous page...

Once you're finished you need to do the following:

1. Save this form to your computer by clicking file/save as...
2. Go back to <https://www.gov.uk/apply-for-a-licence/temporary-event-notice/leicester/apply-1> to upload this file and continue with your application.

Don't forget to make sure you have all your supporting documentation to hand.



**Licensing Act 2003
Objection to Temporary Event Notice (TEN)**

Details of Relevant Authority

Name and Job Title: Andrew Sansome, Pollution Control Officer

Address: Noise Team, Leicester City Council, A4, New Walk Centre, Welford Place,
Leicester. LE1 6ZG

Phone Number: 0116 454 3061

Fax Number: 0116 252 6444

Details of Premises Representation is about

Name of Premises: The Sportsman

Address: 43 Park Rise, Leicester, LE3 6SG

Application Number: 059727

Our Reference: 14/02928/PNCNLT

This objection relates to the following licensing objective(s):

Prevention of crime and disorder

No

Public Safety

No

Prevention of public nuisance

Yes

Protection of children from harm

No

Representation

I wish to make representation in connection with this application for a temporary event notice (TEN) as I consider this proposal will be detrimental to the licensing objective of public nuisance.

REASONS

The premises are situated in a residential area. The applicant has applied for a Temporary Event Notice to run on consecutive weekend days (28 March to 30 March 2014) from 12.00 (noon) to 06.00 hours on two days and 12.00 midday until 23.00 on the third day.

There are a number of residential properties near to the premises. Noise complaints have been made regarding noise from the premises in 2008, 2009, 2010, 2011 and 2013. Noise nuisances have been witnessed by Leicester City Council Environmental Health Officers in 2009 and 2010.

I am concerned that noise breakout from the premises, noise from customers using the outside of the premises, noise from people and vehicles arriving and leaving in the early hours will affect numerous properties near and around the premises therefore there is an increased likelihood of noise disruption and complaint.

I am of the opinion that it will be very difficult to implement controls or conditions on the Notice and therefore recommend that the application be **refused**.

I have informed the applicant of my objection to this application.

Send / email to:

- 1) Licensing Officer (NAME)
Licensing
New Walk Centre
Leicester
LE1 6ZG
- 2) Applicant
- 3) Leicestershire Police (liquor.licensing@leicestershire.pnn.police.uk)

Please ask for: Amy Day
Direct Line: (0116) 252 8550
Our Ref: LEIPRM0841
Date: 16 April 2013



Leicester
City Council

Licensing Authority Office
New Walk Centre
Leicester, LE1 6ZG

www.leicester.gov.uk/licensing
e-mail: licensing@leicester.gov.uk

Flint Bishop Solicitors
St Michaels Court
St Michaels Lane
Derby
DE1 3HQ

Dear Sirs

**Sportsman
Park Rise**

Your application to change the designated premises supervisor for the above premises licence has been processed. The updated licence is enclosed, together with a summary.

May I take this opportunity to remind you that Section 57 of the Licensing Act 2003 states;

"(2) The holder of the premises licence must secure that the licence or a certified copy of it is kept at the premises in the custody or under the control of

- a) the holder of the licence, or
- b) a person who works at the premises and whom the holder of the licence has nominated in writing...

(3) The holder of the premises licence must secure that

- a) the summary of the licence or a certified copy of that summary, and
- b) a notice specifying the position held at the premises by any person nominated for the purposes of subsection (2),
are displayed prominently at the premises."

It is an offence to fail to comply with the above requirements.

A questionnaire is enclosed, the results of which will enable us to monitor and improve the service we provide. I would be grateful if you could fill it in and return it to the Licensing Section at the address shown above.

If you have any queries, please contact the Licensing Section on (0116) 2527000 or email licensing@leicester.gov.uk.

Yours sincerely,

Amy Day
Licensing Officer
amy.day@leicester.gov.uk



Licensing Authority Office
Leicester City Council
New Walk Centre
Welford Place
LEICESTER
LE1 6ZG

Part 1 - Premises Details

POSTAL ADDRESS OF PREMISES, OR IF NONE, ORDNANCE SURVEY MAP REFERENCE OR DESCRIPTION

Sportsman

Park Rise, Western Park, Leicester, LE3 6SG.

Telephone 0116 287 1820

WHERE THE LICENCE IS TIME LIMITED THE DATES

Not applicable

Expires **no expiry**

LICENSABLE ACTIVITIES AUTHORISED BY THE LICENCE

- an exhibition of a film
- an indoor sporting event
- a performance of live music
- any playing of recorded music
- a performance of dance
- provision of late night refreshment
- the supply of alcohol

THE TIMES THE LICENCE AUTHORISES THE CARRYING OUT OF LICENSABLE ACTIVITIES

Activity (and Area if applicable)	Description	Time From	Time To
B. Exhibition of films (Indoors)	Mon-Wed	10:00am	11:00pm
	Thurs-Sat	10:00am	Midnight
	Sunday	10:00am	11:00pm
C. Indoor sporting event	Mon-Wed	10:00am	11:00pm
	Thurs-Sat	10:00am	Midnight
	Sunday	10:00am	11:00pm
E. Performance of live music (Indoors)	Mon-Wed	10:00am	11:00pm
	Thurs-Sat	10:00am	Midnight
	Sunday	10:00am	11:00pm
F. Playing of recorded music (Indoors)	Mon-Wed	10:00am	11:00pm
	Thurs-Sat	10:00am	Midnight
	Sunday	10:00am	11:00pm
G. Performance of dance (Indoors)	Mon-Wed	10:00am	11:00pm
	Thurs-Sat	10:00am	Midnight
	Sunday	10:00am	11:00pm



Premises Licence



Licensing Authority Office
Leicester City Council
New Walk Centre
Welford Place
LEICESTER
LE1 6ZG

THE TIMES THE LICENCE AUTHORISES THE CARRYING OUT OF LICENSABLE ACTIVITIES continued ...

Activity (and Area if applicable)	Description	Time From	Time To
I. Late night refreshment (Indoors)	Mon-Wed	11:00pm	11:30pm
	Thurs-Sat	11:00pm	12:30am
	Sunday	11:00pm	11:30pm
J. Supply of alcohol for consumption ON and OFF the premises	Mon-Wed	10:00am	11:00pm
	Thurs-Sat	10:00am	Midnight
	Sunday	10:00am	11:00pm

THE OPENING HOURS OF THE PREMISES

Description	Time From	Time To
Mon-Wed	10:00am	11:30pm
Thurs-Sat	10:00am	12:30am
Sunday	10:00am	11:30pm

WHERE THE LICENCE AUTHORISES SUPPLIES OF ALCOHOL WHETHER THESE ARE ON AND / OR OFF SUPPLIES

- J. Supply of alcohol for consumption ON and OFF the premises

Part 2

NAME, (REGISTERED) ADDRESS, TELEPHONE NUMBER AND EMAIL (WHERE RELEVANT) OF HOLDER OF PREMISES LICENCE

Marstons PLC

Marston's House, Brewery Road, Wolverhampton, WV1 4JT.

REGISTERED NUMBER OF HOLDER, FOR EXAMPLE COMPANY NUMBER, CHARITY NUMBER (WHERE APPLICABLE)

NAME, ADDRESS AND TELEPHONE NUMBER OF DESIGNATED PREMISES SUPERVISOR WHERE THE PREMISES LICENCE AUTHORISES THE SUPPLY OF ALCOHOL

Nicholas GILLESPIE

PERSONAL LICENCE NUMBER AND ISSUING AUTHORITY OF PERSONAL LICENCE HELD BY DESIGNATED PREMISES SUPERVISOR WHERE THE PREMISES LICENCE AUTHORISES FOR THE SUPPLY OF ALCOHOL

Licence No. 009535

Issued by Newcastle-under-Lyme





Licensing Authority Office
Leicester City Council
New Walk Centre
Welford Place
LEICESTER
LE1 6ZG

ANNEXES

Annex 1 - Mandatory conditions

Supply of alcohol - on the premises

No supply of alcohol may be made under the premises licence -

- a) at a time when there is no designated premises supervisor in respect of the premises licence, or
- b) at a time when the designated premises supervisor does not hold a personal licence or his personal licence is suspended.

Every supply of alcohol under the premises licence must be made or authorised by a person who holds a personal licence.

The responsible person shall take all reasonable steps to ensure that staff on relevant premises do not carry out, arrange or participate in any irresponsible promotions in relation to the premises. In this paragraph, an irresponsible promotion means any one or more of the following activities, or substantially similar activities, carried on for the purpose of encouraging the sale or supply of alcohol for consumption on the premises in a manner which carries a significant risk of leading or contributing to crime and disorder, prejudice to public safety, public nuisance, or harm to children-

- a) games or other activities which require or encourage, or are designed to require or encourage, individuals to-
 - i) drink a quantity of alcohol within a time limit (other than to drink alcohol sold or supplied on the premises before the cessation of the period in which the responsible person is authorised to sell or supplied alcohol), or
 - ii) drink as much alcohol as possible (whether within a time limit or otherwise);
- b) provision of unlimited or unspecified quantities of alcohol free or for a fixed or discounted fee to the public or to a group defined by a particular characteristic (other than any promotion or discount available to an individual in respect of alcohol for consumption at a table meal, as defined in section 159 of the Act);
- c) provision of free or discounted alcohol or any other thing as a prize to encourage or reward the purchase and consumption of alcohol over a period of 24 hours or less;
- d) provision of free or discounted alcohol in relation to the viewing on the premises of a sporting event, where that provision is dependent on-
 - i) the outcome of a race, competition or other event or process, or
 - ii) the likelihood of anything occurring or not occurring;
- e) selling or supplying alcohol in association with promotional posters or flyers on, or in the vicinity of, the premises which can reasonably be considered to condone, encourage or glamorise anti-social behaviour or to refer to the effects of drunkenness in any favourable manner.

The responsible person shall ensure that no alcohol is dispensed directly by one person into the mouth of another (other than where that other person is unable to drink without assistance by reason of a disability).

The responsible person shall ensure that free tap water is provided on request to customers where it is reasonably available.

The premises licence holder or club premises certificate holder shall ensure that an age verification policy applies to the premises in relation to the sale or supply of alcohol. The policy must require individuals who appear to the responsible person to be under 18 years of age (or such older age as may be specified in the policy) to produce on request, before being served alcohol, identification bearing their photograph, date of birth and a holographic mark.

The responsible person shall ensure that-

- a) where any of the following alcoholic drinks is sold or supplied for consumption on the premises (other than alcoholic drinks sold or supplied having been made up in advance ready for sale or supply in a securely closed container) it is available to customers in the following measures-
 - i) beer or cider: ½ pint;
 - ii) gin, rum, vodka or whisky: 25 ml or 35 ml; and
 - iii) still wine in a glass: 125 ml; and

customers are made aware of the availability of these measures.

Supply of alcohol - off the premises

No supply of alcohol may be made under the premises licence -

- a) at a time when there is no designated premises supervisor in respect of the premises licence, or
- b) at a time when the designated premises supervisor does not hold a personal licence or his personal licence is suspended.

Every supply of alcohol under the premises licence must be made or authorised by a person who holds a personal licence.

The premises licence holder or club premises certificate holder shall ensure that an age verification policy applies to the premises in relation to the sale or supply of alcohol. The policy must require individuals who appear to the responsible person to be under 18 years of age (or such





Licensing Authority Office
Leicester City Council
New Walk Centre
Welford Place
LEICESTER
LE1 6ZG

ANNEXES continued ...

older age as may be specified in the policy) to produce on request, before being served alcohol, identification bearing their photograph, date of birth and a holographic mark.

Admission of children to the exhibition of any film must be in accordance with the recommendations of the British Board of Film Classification for that film. Where permission has been given by the Licensing Authority to show a film not classified by the British Board of Film Classification, the requirements made by the Licensing Authority for the admission of children to the exhibition of that film must be followed.

All individual(s) at the premises for the purpose of carrying out a security activity must be licensed by the Security Industry Authority.

Annex 2 - Conditions consistent with the operating schedule

The restrictions in this Annex do not prohibit any sale, supply or consumption of alcohol previously permitted by the Licensing Act 1964.

Licensable activities may continue between the end of the hours permitted by the licence on New Years Eve and the start of the hours permitted by the licence on New Years Day.

The Licence Holder shall ensure that any person exercising a security activity is employed at the discretion of the designated premises supervisor/holder of premises licence, and that, that such persons shall clearly display his name badge at all times whilst on duty.

The Licence Holder shall ensure that no customers apparently carrying open bottles upon entry are admitted to the premises at any time the premises is open to the public.

The Licence Holder shall ensure that where CCTV is installed with recording facilities, such recordings are retained for a period of 30 days and made available within a reasonable time upon request by the Police.

The Licence Holder shall ensure that alcoholic and other drinks are not removed from the premises in open containers, save for consumption in any external area provided for that purpose.

The Licence Holder shall ensure that noise or vibration does not manate from the premises so as to cause a nuisance to nearby properties.

The Licence Holder shall ensure that children under the age of 16 are not permitted to enter the premises after 21.00.

Non-Standard Timings

To permit the premises to open for licensable activities to show the broadcast of televised sporting events of national or international interest outside normal operating hours such opening times for this purpose to be confirmed upon 7 days prior notice in writing to the Police before the premises intend to open, such notification to include the opening times and the sporting event which is to be shown.

Friday, Saturday, Sunday & Monday of a Bank Holiday Weekend	01.00 - end of licensable activities
Christmas Eve	01.00 - end of licensable activities
Boxing Day	01.00 - end of licensable activities

To permit the premises to open until 01.00 on up to 20 occasions per annum at the licence holders discretion upon 7 days prior notice to the Police (if required by them)

The premises to close 30 minutes after the end of the non-standard timings as detailed above.

Annex 3 - Conditions attached after a hearing by the Licensing Authority

A sign to be placed on the premises asking customers to leave the premises quietly.

Doors and windows to remain closed when amplified music is being played.



ANNEX 4 - THE PLAN

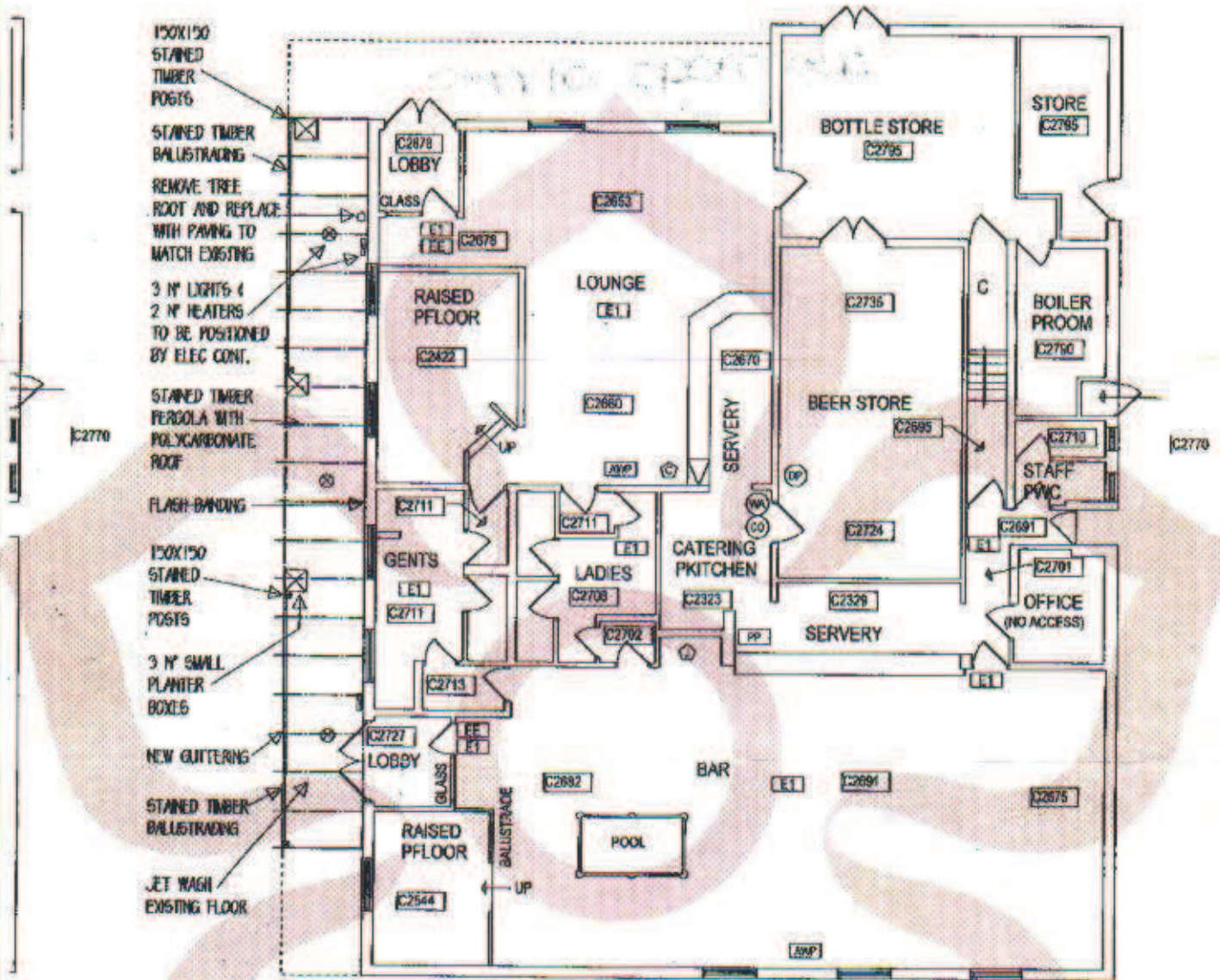

PROPOSED 'ALFRESCO' LAYOUT

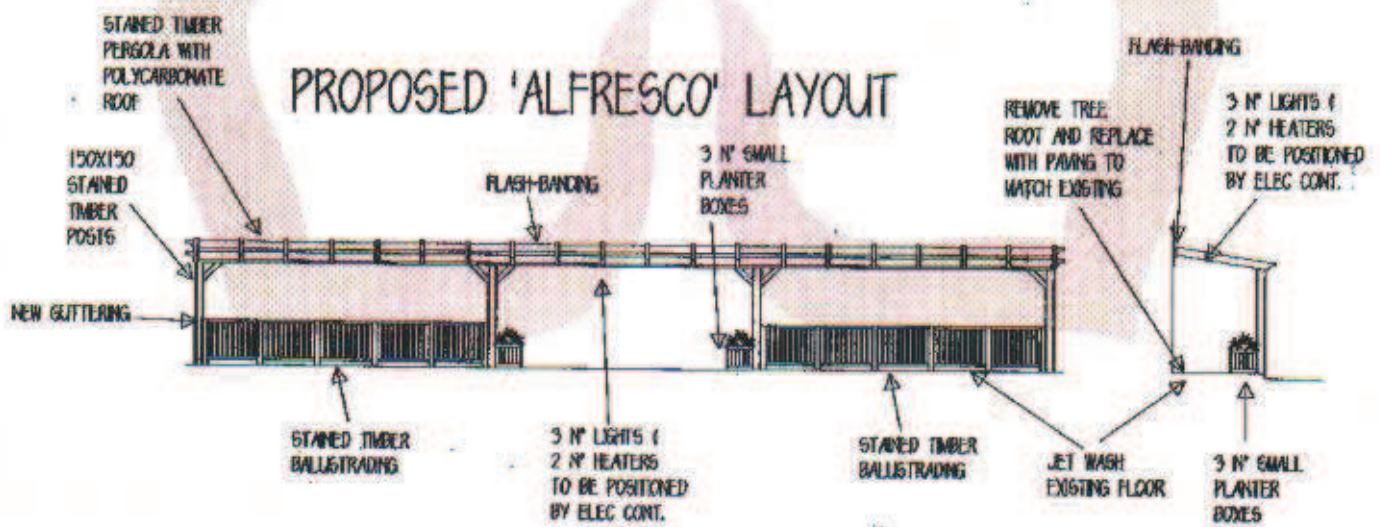

PROPOSED ELEVATIONS

Premises Licence Summary



Licensing Authority Office
Leicester City Council
New Walk Centre
Welford Place
LEICESTER
LE1 6ZG

Premises Details

POSTAL ADDRESS OF PREMISES, OR IF NONE, ORDNANCE SURVEY MAP REFERENCE OR DESCRIPTION

Sportsman

Park Rise, Western Park, Leicester, LE3 6SG

Telephone 0116 287 1820

WHERE THE LICENCE IS TIME LIMITED THE DATES

Not applicable

LICENSABLE ACTIVITIES AUTHORISED BY THE LICENCE

- an exhibition of a film
- an indoor sporting event
- a performance of live music
- any playing of recorded music
- a performance of dance
- provision of late night refreshment
- the supply of alcohol

THE TIMES THE LICENCE AUTHORISES THE CARRYING OUT OF LICENSABLE ACTIVITIES

Activity (and Area if applicable)	Description	Time From	Time To
B. Exhibition of films (Indoors)	Mon-Wed	10:00am	11:00pm
	Thurs-Sat	10:00am	Midnight
	Sunday	10:00am	11:00pm
C. Indoor sporting event	Mon-Wed	10:00am	11:00pm
	Thurs-Sat	10:00am	Midnight
	Sunday	10:00am	11:00pm
E. Performance of live music (Indoors)	Mon-Wed	10:00am	11:00pm
	Thurs-Sat	10:00am	Midnight
	Sunday	10:00am	11:00pm
F. Playing of recorded music (Indoors)	Mon-Wed	10:00am	11:00pm
	Thurs-Sat	10:00am	Midnight
	Sunday	10:00am	11:00pm
G. Performance of dance (Indoors)	Mon-Wed	10:00am	11:00pm
	Thurs-Sat	10:00am	Midnight
	Sunday	10:00am	11:00pm





Licensing Authority Office
Leicester City Council
New Walk Centre
Welford Place
LEICESTER
LE1 6ZG

THE TIMES THE LICENCE AUTHORISES THE CARRYING OUT OF LICENSABLE ACTIVITIES continued ...

Activity (and Area if applicable)	Description	Time From	Time To
I. Late night refreshment (Indoors)	Mon-Wed	11:00pm	11:30pm
	Thurs-Sat	11:00pm	12:30am
	Sunday	11:00pm	11:30pm
J. Supply of alcohol for consumption ON and OFF the premises	Mon-Wed	10:00am	11:00pm
	Thurs-Sat	10:00am	Midnight
	Sunday	10:00am	11:00pm

THE OPENING HOURS OF THE PREMISES

Description	Time From	Time To
Mon-Wed	10:00am	11:30pm
Thurs-Sat	10:00am	12:30am
Sunday	10:00am	11:30pm

WHERE THE LICENCE AUTHORISES SUPPLIES OF ALCOHOL WHETHER THESE ARE ON AND / OR OFF SUPPLIES

- J. Supply of alcohol for consumption ON and OFF the premises

NAME, (REGISTERED) ADDRESS OF HOLDER OF PREMISES LICENCE

Marstons PLC

Marston's House, Brewery Road, Wolverhampton, WV1 4JT.

REGISTERED NUMBER OF HOLDER, FOR EXAMPLE COMPANY NUMBER, CHARITY NUMBER (WHERE APPLICABLE)
NAME OF DESIGNATED PREMISES SUPERVISOR WHERE THE PREMISES LICENCE AUTHORISES THE SUPPLY OF ALCOHOL

Nicholas GILLESPIE

STATE WHETHER ACCESS TO THE PREMISES BY CHILDREN IS RESTRICTED OR PROHIBITED

Restricted in accordance with the Licensing Act 2003.

